



PT20i

NEW!

Noblelift Power Electric Pallet Truck With Mast Lift for Order Picking

The PT 20i is the ideal choice if transportation operations needs to be combined with health friendly order picking operations. The low-lift transportation capacity of max.2000kg is enough to unload delivery lorries and to do picking operations in the warehouse or in the salesroom. The sideways lifting buttons are ergonomically located nearby the picking area.

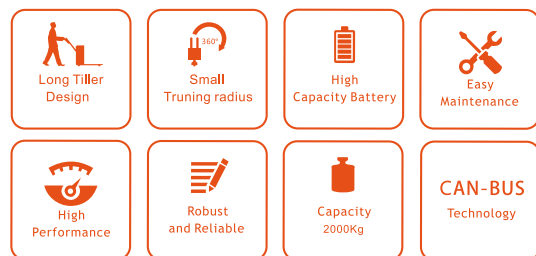

DOUBLE LIFTING DESIGN CORE COMPONENTS FORM TOP QUALITY BRANDS

- Initial lifting
- Easy for operation
- Side-way battery replacement
- Capacities for different applications

ADVANTAGE:

- Power pallet truck with additional health-friendly mast lift
- AC drive system
- Long tiller for easy and ergonomic operations
- Slow-speed button for safe operations in narrow spaces

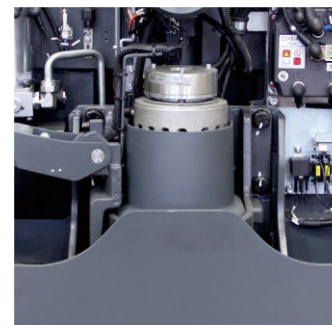

Core Components from Top Quality Brands

German KORDEL gear box, INTORQ Brake, WICK drive wheel, Italian ZAPI Controller ensure the high performance, efficiency and stability, at the same time reduce the running cost .



Robust and Reliable Design

The robust chassis with the strong 8mm thick apron protects the truck and the components against mechanical impacts from the outside. The steel battery cover ensures the battery well protected.



Static design of the hydraulic system

There is no movement of the hydraulic systems during lifting and lowering of the truck, ensures the stability and safety of the hydraulic system .



Long Tiller Design

Ergonomically designed long tiller allows comfortable and efficient operation, and at the same time safety for the operator by keeping a safe distance.

CAN-BUS

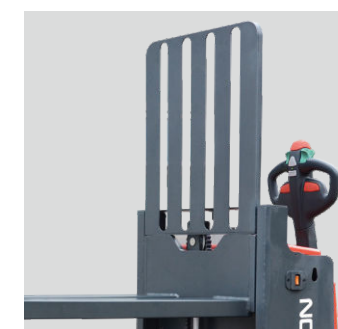

Initial lifting(double lifting design)

Additional healthy-friendly mast lift height up to 800mm with lift capacity 1000kg, ideal for trailer unloading, short distance material transportation and factory assembly line.



Tiger Series

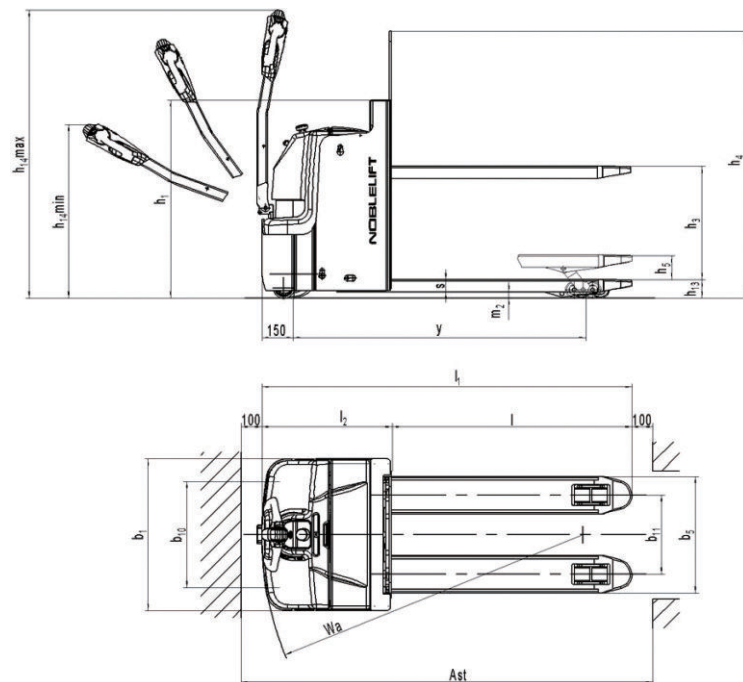

Ttype sheet for industrial truck acc. to VDI 2198 1KG=2.2LB 1INCH=25.4MM

Distinguishing mark	1.2	Manufacturer's type designation		PT 20I	
	1.3	Drive		Battery	
	1.4	Operator type		Pedestrian	
	1.5	Load capacity / rated load	Q (t)	2.0	
		Load capacity at mast lift	Q (t)	1.0 ¹⁾	
		Load capacity at support arm lift	Q (t)	2.0 ¹⁾	
	1.6	Load center distance	C (mm)	600	
	1.8	Load distance ,centre of drive axle to fork	X (mm)	916	
	1.9	Wheelbase	Y (mm)	1386	1557
Weight	2.1	Service weight	kg	656	855
	2.2	Axle loading, laden front/rear	kg	765/1891	845/2010
	2.3	Axle loading, unladen front/ rear	kg	476/180	612/243
Tires, chassis	3.1	Tires		Polyurethane (PU)	
	3.2	Tire size, front	Ø x w (mm)	Ø230 x70	
	3.3	Tire size, rear	Ø x w (mm)	Ø80x70	
	3.4	Additional wheels(dimensions)	Ø x w (mm)	Ø100x40	
	3.5	Wheels, number front/ rear(x=driven wheels)		1x+2/4	
	3.6	Tread, front	b10 (mm)	510	
	3.7	Tread, rear	b11 (mm)	380	
Dimensions	4.2	Lowered mast height	h1 (mm)	950	855
	4.4	lift	h3 (mm)	550	
	4.5	Extended maximal height	h4 (mm)	1717	1558
	4.6	Initial lift	h5 (mm)	120	
	4.9	Height of tiller in drive position min./ max.	h14 (mm)	820/1335	
	4.15	Height, lowered	h13 (mm)	88	
	4.19	Overall length	l1 (mm)	1770	1940
	4.20	Length to face of forks	l2 (mm)	620	790
	4.21	Overall width	b1 (mm)	729	
	4.22	Fork dimensions	s/e/l (mm)	60 / 180 / 1150	
	4.25	Distance between fork- arms	b5 (mm)	560	
	4.32	Ground clearance, centre of wheelbase	m2 (mm)	28	
	4.33	Aisle width for pallets 1000x1200 crossways	Ast (mm)	1970	2041
	4.34	Aisle width for pallets 800x1200 lengthwise	Ast (mm)	2020	2091
	4.35	Turning radius	Wa (mm)	1536	1707
Performance	5.1	Travel speed, laden/ unladen	km/h	6.0/ 6.0	
	5.2	Lift speed, laden/ unladen	mm/s	95/ 150	85/140
	5.3	Lowering speed, laden/ unladen	mm/s	90/ 70	80/65
	5.8	Max. gradeability, laden/ unladen	%	8/ 20	
	5.10	Service brake		Electromagnetic	
Motors	6.1	Drive motor rating S2 60min	kW	1.3	1.7
	6.2	Lift motor rating at S3 10%	kW	1.2	2.2
	6.3	Battery acc. to DIN 43531/ 35/ 36 A, B, C, no		No, 2VBS	No, 3VBS
	6.4	Battery voltage, nominal capacity K5	V/Ah	24/ 160	24/ 210
	6.5	Battery weight	kg	150	185
	6.6	Energy consumption acc. to VDI cycle	kWh/h	1.0	
Addition data	8.1	Type of drive control		AC- speed control	
	8.4	Sound level at driver's ear acc. to EN 12053	dB(A)	<70	

1) in double-deck operation: mast lift 1.0t,,support arm lift 1.0t